

BENEFITS

Highest Efficiency

Panel efficiency of 18.1% is the highest commercially available for residential applications

Attractive Design

Unique design combines high efficiency and an elegant, all-black appearance

More Power

Delivers up to 50% more power per unit area than conventional solar panels

Reliable and Robust Design

Proven materials, tempered front glass, and a sturdy anodized frame allow panel to operate reliably in multiple mounting configurations



225 SOLAR PANEL

EXCEPTIONAL EFFICIENCY AND APPEARANCE

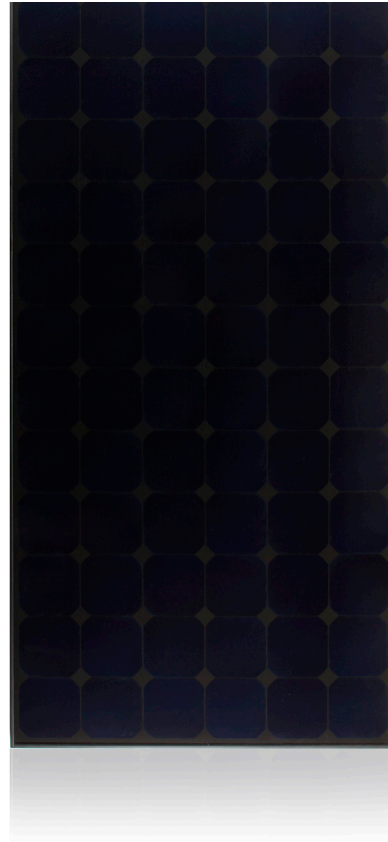

The SunPower 225 Solar Panel provides a revolutionary combination of high efficiency and attractive, uniform appearance. Utilizing 72 next generation SunPower all-back contact solar cells and an all-black backsheet, the SunPower 225 elegantly delivers an unprecedented total panel conversion efficiency of 18.1%. The panel's reduced voltage-temperature coefficient and exceptional low-light performance attributes provide far higher energy delivery per peak power than conventional panels.

SunPower's High Efficiency Advantage - up to 50% More Power

Comparable systems covering 25 m² / 270 ft²

| | Conventional | SunPower |
|---------------|--------------|----------|
| Watts / Panel | 165 | 225 |
| Efficiency | 12.0% | 18.1% |
| kWs | 3.0 | 4.5 |

Electrical Data

Measured at Standard Test Conditions (STC): irradiance of 1000 W/m², air mass 1.5g, and cell temperature 25° C

| | | |
|--------------------------|----------------------------|---|
| Peak Power (+/-5%) | P _{max} | 225 W |
| Rated Voltage | V _{mp} | 41.0 V |
| Rated Current | I _{mp} | 5.49 A |
| Open Circuit Voltage | V _{oc} | 48.5 V |
| Short Circuit Current | I _{sc} | 5.87 A |
| Maximum System Voltage | IEC, UL | 1000 V, 600 V |
| Temperature Coefficients | | |
| | Power | -0.38% /°C |
| | Voltage (V _{oc}) | -132.5 mV/°C |
| | Current (I _{sc}) | 3.5 mA/°C |
| Series Fuse Rating | | 20 A |
| Peak Power per Unit Area | | 181 W/m ² , 16.8 W/ft ² |
| CEC PTC Rating | | 207.1 W |

Mechanical Data

| | |
|---------------|--|
| Solar Cells | 72 SunPower all-back contact monocrystalline |
| Front Glass | 3.2 mm (1/8 in) tempered |
| Junction Box | IP-65 rated with 3 bypass diodes |
| Output Cables | 900mm length cable / MultiContact connectors |
| Frame | Anodized aluminum alloy type 6063 |
| Weight | 15 kg, 33 lbs |

IV Curve

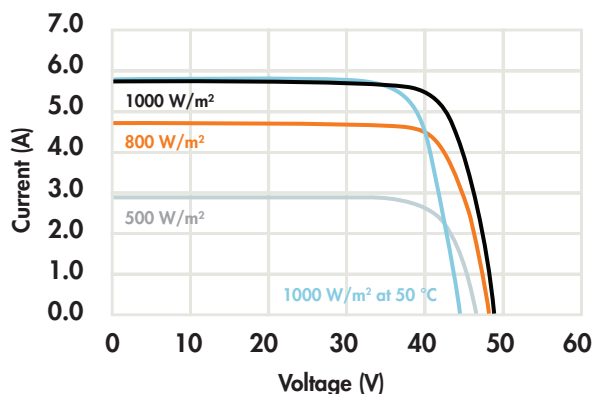

Current/voltage characteristics with dependence on irradiance and module-temperature.

Tested Operating Conditions

| | |
|-------------------|--------------------------------------|
| Temperature | -40° C to +90° C (-40°F to +194°F) |
| Max load | 50 psf (2400 pascals) front and back |
| Impact Resistance | Hail -25mm (1 in) at 23 m/s (52 mph) |

Warranty and Certifications

| | |
|----------------|--|
| Warranty | 25 year limited power warranty 10 year limited product warranty |
| Certifications | IEC 61215, Safety tested IEC 61730 UL listed (UL 1703), Class C Fire Rating |

Dimensions

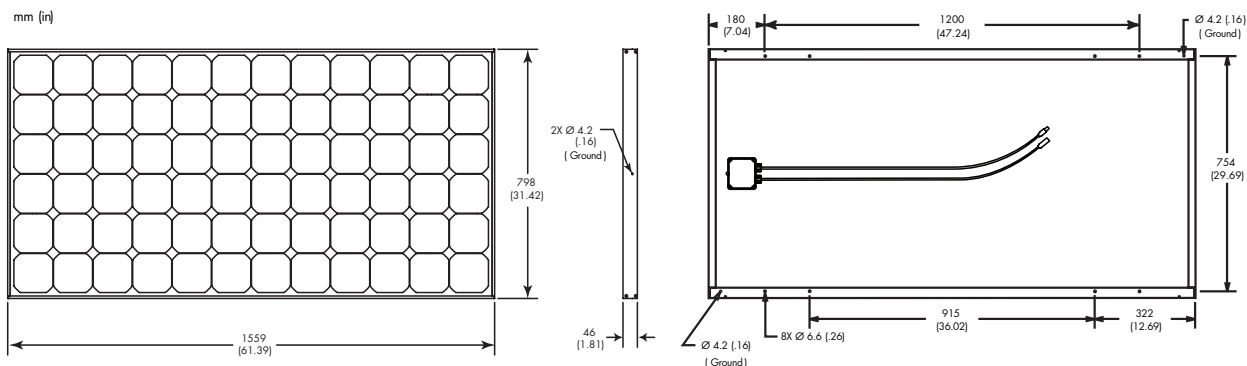

CAUTION: READ SAFETY AND INSTALLATION INSTRUCTIONS BEFORE USING THE PRODUCT. Go to www.sunpowercorp.com/panels for details

About SunPower

SunPower designs, manufactures and delivers high-performance solar electric technology worldwide. Our high-efficiency solar cells generate up to 50 percent more power than conventional solar cells. Our high-performance solar panels, roof tiles and trackers deliver significantly more energy than competing systems.